

THE AUSTRALIAN AND NEW ZEALAND SOCIETY OF OCCUPATIONAL MEDICINE



40 YEARS

**THE CHALLENGE:
A HEALTHY AND SAFE WORKPLACE**

1-4 September 2011

**Wellington School of Medicine
University of Otago
23A Mein Street, Newtown**

WELCOME

ANZSOM celebrates 40 years as a combined Australian and New Zealand Society and on behalf of the Organising Committee, I would like to welcome you to Wellington for the ANZSOM (NZ) Inc 2011 Annual Scientific Meeting on such a special occasion.

ANZSOM is one of a number of similar Societies world-wide. The SOM in the UK (which recently celebrated 75 years), the SOM in Ireland, and the Malaysian Society of Occupational Health Physicians are just a few. They are united by common aims:

- Their inclusiveness;
- Their close links to the grass roots of occupational medical practice;
- Their innovation.

They recognise diversity and a multidisciplinary approach to occupational medical and safety practice. These themes will run through this scientific meeting.

We have combined an interesting scientific meeting with an excellent venue. Please make the most of the Wellington School of Medicine and the surrounds.

We look forward to sharing this event with you.

Simon Ryder-Lewis

President ANZSOM (NZ) Inc

KEYNOTE SPEAKERS

Dr Ron Loeppeke

Vice Chairman, Board of US Preventive Medicine Inc.

Prof Des Gorman

Executive Chairman, Health Workforce New Zealand

Prof Jeroen Douwes

Director, Centre for Public Health Research, Massey University

Mr Paul Jarvie

Manager, Occupational Health and Safety Employers and Manufacturers Association (Northern) Inc.

Mr Les Heads

SHE Manager, Pacific National Rail.

Prof Tar-Ching Aw

Chair, Department of Community Medicine

Faculty of Medicine and Health Sciences, United Arab Emirates University.

Prof Ken Takahashi

Professor of Environmental Epidemiology and Acting Director of the WHO Collaborating Centre for Occupational Health at University of Occupational and Environmental Health (UOEH), Kitakyushu, Japan.

TOPICS INCLUDE

- Occupational Medicine – Its Future, Its Role and Training
- Occupational Medicine, Primary Health Care and Prevention
- Health, Safety and Welfare at Work – A Multidisciplinary Practice
- Occupational Research in New Zealand:
 - Dust and Timber Workers
 - Solvents and Car Spray Painters
 - Cancer and Meat Workers
- Real Time Video Exposure Monitoring – A New Investigative Tool

- Ongoing Issues in Occupational Medicine
 - Chronic Pain
 - Solvent Neurotoxicity
- Occupational Health in Developing Countries
- Health Surveillance at Work

GENERAL INFORMATION

Registration

The Registration Desk will be open from 8.00am. The Organising Committee members welcome all queries regarding local information and Conference details.

Name Badges

Entry to meeting sessions will be restricted to name badge holders only. We request that delegates wear their name badge throughout the Conference.

All Organising Committee members will be wearing red coloured name tags for ease of identification.

Buses to the Venue

Complimentary buses are available to take you from the below Hotels to the Conference Venue and return you at the end of each day.

- West Plaza
- Museum Hotel
- Cophorne, Oriental Bay.

If you require transport- please e-mail simon@workhealthsolutions.co.nz and we will arrange for you to be collected.

Parking

Free Parking is available on **Saturday and Sunday only** at St. Annes Church, Emmett St, Newtown. Turn left off Riddiford St (past Mein St), at the BNZ bank into Emmett St. Park on the playground between St. Annes Church and their church hall. See Map

Refreshments

Morning tea, afternoon tea and lunch will be served on each day in the Lobby. On Saturday and Sunday the Café area will also be available for our use.

Mobile Phones / Pagers/ Internet

Mobile phones and pagers must be either turned off or set to vibrate during meeting sessions.

Wellington Central Business District including the Waterfront has free Wireless Internet (Wifi) available for your use.

TELEPHONE DIRECTORY

Venue

Wellington School of Medicine Ph. (04) 385 5541
23A Mein St, Newtown, Wellington

Emergency

**Ambulance/
Fire/Police** Dial 111

Wellington Accident & Urgent Medical Centre Ph (04) 384 4944 (8 am-11pm)
Physical Address: 17 Adelaide Road, Newtown

Urgent Pharmacy Ph (04) 385 8810 **Physical Address:** 17 Adelaide Road, Newtown

Useful Contacts

Taxis

Wellington
Combined: Ph: (04) 384 4444

Wellington
Green Cabs: Ph: 0508 44 7336

Wellington
Corporate Cabs Ph: (04) 387 4600

Visitor Info Centre: Ph: (04) 802 4860 **Physical Address:** Cnr Victoria & Wakefield St

SOCIAL FUNCTIONS

Welcome Function - Thursday 1st September 6:30- 8:30 pm

As a welcome reception, please join us at The Wellington Club for drinks and hors d'oevres

The Wellington Club, 88 The Terrace, Wellington City.

Note: Dress Code: Gentleman Sports Jacket and Tie Please. Ladies smart attire please.

Afterwards, enjoy the many bars, cafes and restaurants that are located within the central city. All within walking distance of the Wellington Club and your hotels.

Conference Dinner - Shed 5, Queens Wharf

Saturday 3rd September 6:30 pm for 7:00 pm start

This award winning restaurant is located on Queens Wharf, in the heart of the city. Enjoy a lively dinner in one of Wellington's smartest and most popular waterfront restaurants.



KEY NOTE SPEAKER BIOGRAPHIES

Ken Takahashi MD, MPH, PhD



Professor of Environmental Epidemiology and Acting Director of the WHO Collaborating Centre for Occupational Health at University of Occupational and Environmental Health (UOEH), Kitakyushu, Japan.

Ken Takahashi graduated School of Medicine of Keio University in 1983, received Ph.D. from UOEH and M.P.H. from the University of Pittsburgh. He is Professor of Environmental Epidemiology and Acting Director of the WHO Collaborating Centre for Occupational Health at the Institute of Industrial Ecological Sciences, University of Occupational and Environmental Health, Japan. Since 2011, he is President of the Asian Conference for Occupational

Health.

He has been serving as consultant/advisor to the World Health Organization and the International Labour Organization to several Asian countries. He has been engaged by a number of academic/research institutes in the Asia-Pacific as examiner and advisor. He has served twice as elected Board Member of ICOH, is current Fellow of the Collegium Ramazzini and editorial board member of several international/domestic scientific journals.

Within Japan, he has been involved in national committees at the ministerial level, appointed as a Consulting Occupational Health Physician to the Prefectural Labor Bureau designated by the Ministry of Health Labour and Welfare, Japan, and chairs a municipal committee on asbestos diseases. He engages in epidemiologic research of occupational diseases with special interest on asbestos diseases.

Professor Takahashi's visit has been sponsored by The National Asbestos Medical Advisory Panel Charitable Trust.

Tar-Ching Aw



- Is head of the Department of Community Medicine at United Arab Emirates University.
- He moved from the University of Kent in Canterbury, UK where he was Professor of Occupational Medicine.
- He has also worked previously at the Institute of Occupational Health in Birmingham, the Health and Safety Executive in London, and at NIOSH (National Institute for Occupational Safety and Health) in Cincinnati, and for the CDC (Centres for Disease Control & Prevention) Atlanta.

- Professor Aw has published over a hundred papers and book chapters, and has recently co-edited the 10th edition of Hunter's Diseases of Occupations.

Ron Loepke, M.D., MPH, FACOEM, FACPM



Ron Loepke, MD, MPH, FACOEM, FACPM is Vice-Chairman of U.S. Preventive Medicine and serves as co-chair of the company's International Advisory Board.

Dr. Loepke has over 30 years of clinical and physician executive experience in the Occupational Health, Preventive Medicine and Medical Management arenas. He has provided over 200 presentations nationally and internationally as well as authored numerous articles and book chapters relating to research studies and initiatives in preventive medicine, employer health and productivity, workplace wellness, occupational health, managed care, quality care

improvement, adoption of evidence based medicine, consumer driven healthcare and innovative models of healthcare delivery.

He is Board Certified in Preventive Medicine; Fellowship trained in Occupational Medicine and is a Fellow of both the American College of Occupational and Environmental Medicine (ACOEM) and the American College of Preventive Medicine, (ACPM). Dr. Loepke is Vice-President of ACOEM as well as a member of the Board of Directors of ACOEM. He also serves as Co-Chairman of the ACOEM Section on Health and Productivity, which is actively involved in defining and establishing measurement criteria for research in health and productivity and best practice case studies in workplace wellness.

Dr. Loepke was the Founder, CEO and President of the Health and Productivity Corporation of America (HPCA), headquartered in Brentwood, Tennessee. HPCA provided health and productivity enhancement services to employers for their employees, dependants, and retirees. In 2003, HPCA was acquired by CorSolutions where Dr. Loepke became the EVP and Chief Strategic Officer. CorSolutions was then acquired by Matria (a publicly traded healthcare company) in 2006, whereupon he continued his role as EVP and Chief Strategic Officer. Alere (also a publicly traded healthcare company) then acquired Matria in 2008, where Dr. Loepke became the EVP of Health and Productivity Strategy.

Dr. Loepke was also previously the Chief Medical Officer of PhyCor, Inc., a publicly traded healthcare company with over 25,000 affiliated physicians and \$1.3 billion in annual revenue, at its peak. Dr. Loepke also founded and was President of Corporate Health and Medical Programs, Inc., which contracted with over 2000 employers (including Kodak, Hewlett Packard, Teledyne Waterpik, Anheuser Busch, ConAgra) for onsite occupational health and preventive medicine services as well as consulting Medical Director Services.

He was also the Chairman of the Department of Occupational Health and Preventive Medicine providing clinical and consultative services at the Greeley Medical Clinic, a large multispecialty physician group practice in Colorado. Dr. Loepke was on the medical staff of the Occupational Medicine section of the National Jewish Hospital and Center for Immunology and Respiratory Medicine in Denver, Colorado.

Jeroen Douwes



Professor Jeroen Douwes is the Director of the Massey University Centre for Public Health Research (CPHR). Jeroen is recognised internationally for his work on indoor and occupational health. His current research programme focuses on asthma causation, mechanisms and prevention. He is currently the principle investigator of studies on occupational dermatitis; neurotoxic effects of solvent exposures; asthma in farmers, veterinary students, and poultry processors; and occupational intervention studies to reduce exposures to hazardous substances. Jeroen has (co)-authored 100+ peer reviewed scientific publications, and is Associate Editor of the International Journal of

Epidemiology and Community Health.

Professor Des Gorman, BSc, MBChB MD (Auck), PhD (Syd)



I am a Professor of Medicine and Associate Dean in the University of Auckland's Faculty of Medical and Health Sciences. I was the Head of the University's School of Medicine from 2005 to 2010 inclusive and was the first graduate of the School to hold that position.

I have a strong interest in the development and maintenance of an effective health workforce. I was a member of the Ministry of Health's Commission on Resident Medical Officers and led the Minister of Health's Taskforce that reviewed the funding of the training of the New Zealand health workforce in

2009; I have subsequently been appointed as the Executive Chairman of Health Workforce New Zealand and as a member of both the National Health Board and the Capital Investment Committee. Finally, I am a member of the Welfare Working Group for the Minister for Social Development.

I have been married to Christine for 32 years and we have three adult daughters and one granddaughter. I have dual Australian and New Zealand citizenship and am ethnically European and New Zealand Māori. My iwi (tribe) is Ngapuhi. In part because of personal experience, I am strongly committed to promoting indigenous peoples' health.

My undergraduate education was at the University of Auckland; I graduated with bachelor's degrees in Science (BSc), and in medicine and surgery (MBChB). I have a doctorate in medicine (MD), which was conferred by the University of Auckland, and a doctorate in philosophy (PhD), which was conferred by the University of Sydney. Both doctorates were awarded on the basis of in vivo research into brain injuries. In addition to brain injuries, my clinical interests are largely in the disciplines of toxicology and occupational medicine.

I served in both the Royal Australian Navy and in the Royal New Zealand Navy. During my service in the former, I trained as a Submarine Officer in the United Kingdom and as a Clearance Diving Officer in Australia and North America. I was the Dux of the Royal Navy's Submarine Officer School in 1982 and was the Royal Australian Navy Officer of the Year in 1984. I am a member of the Expert Panel on Veterans' Health for the New Zealand Department of Veterans Affairs.

Les Heads



Les Heads began his work life as a labourer in a Southland country town. He left home at aged 17 and spent the next 34 years working all over the world; in early life as a shearer, oil rig worker, builder's labourer, smelter worker.

Les suffered an occupational illness and stubbornly educated himself firstly in 1990 a Diploma Occupational Health Practice through the University of Otago leading to a Master's in Occupational Safety and Health through Edith Cowan University in 1999. Since this time Les has worked in a management role for health and safety for the NZCTU and 17 years in mining including New Zealand, Australia, Mali (West Africa), Chile, Argentina, Papa New Guinea and USA and 3 years in the rail industry in Australia.

Paul Jarvie



I am currently Manager for OH&S at the Employers and Manufacturers Association (EMA) Northern. EMA has over 8000 members in the top half of the north island. Main functions are:

- Advocating on behalf of employers at the political level
- Providing OH&S audit services
- Accident investigation services for serious injury accidents
- Delivering training for OH&S

I began my working career as a Physiotherapist both in private and public practice. I worked at Mt Isa mine as their physiotherapist/ ergonomist for 4 years. The mine employed over 5000 staff of which 3000 were underground.

On return to NZ I went back and studied Occupational Health and Safety at Massey and Otago universities.

My work has included the following points:

- NZ Delegate writing AS/NZS 4801 and 4804 Occupational health and safety standards and audit tool.
- Current member of the Workplace Health and Safety Council, an advisory committee to the Ministers of ACC and Labour
- Member of the NZ Injury prevention strategy committee.
- On the Examinations committee for the NIDMAR programme
- NZ Delegate for the International Labour Organisation (ILO) developing Codes of Practice, Workplace
- On a research committee based in Colorado State University for Agriculture research on injury prevention in the dairy sector.
- National Operations Manager for NZ Institute of Safety Management (Past National Manager)
- Occupational Health and Safety Industry Group "OHSIG" chairperson. This group is a forum for all OH&S associations in NZ
- Sits on many Dept of labour and ACC committees as the employers' representative.
- Presented numerous papers at many conferences.

THE CHALLENGE – A HEALTHY AND SAFE WORKPLACE

Wellington School of Medicine, 23A Mein Street, Newtown
2, 3, and 4 September 2011

THURSDAY 1 SEPTEMBER 2011

WELCOME RECEPTION

Evening

6.30-8.30 **The Wellington Club, 88 The Terrace, Wellington City.**

Note: Dress Code: Gentleman Sports Jacket and Tie Please. Ladies Smart attire please.

FRIDAY 2 SEPTEMBER 2011

DAY 1: THE CHALLENGES

MORNING-Nordmeyer Lecture Theatre

8.00- 8.25 Registration- **Lobby.**

8.25-8.30 Welcome Dr. Simon Ryder-Lewis,
President, ANZSOM New Zealand.

8.30-9.30 Chair: Dr. Peter Robinson
Keynote Address – Prof. Des Gorman
“The future role and training of
occupational medicine in New Zealand”.

9.30-10.00 Commentators and Discussion: Dr. Rob
McCartney/Dr. Krishnan/Dr. Paul
Gueret.

10.00-10.30 Morning Tea- **Lobby**

Nordmeyer Lecture Theatre

Ongoing Issues in Occupational Medicine

Chair: Dr. Edwin Whiteside

10.30-11.30 **Keynote Address – Prof. Ken Takahashi**
“Findings from situational analyses of
asbestos-related diseases in the world”.

11.30-12.00 **Paper 1** – Mr. Ralf Schnabel: “Solvent
Neurotoxicity”.

12.00-12.30 **Paper 2** – Dr. John Alchin: “Chronic
Pain”.

LUNCH- Lobby

12.30-1.30 Working Lunch-
General Council Meeting- **Rm D07,**
ANZSOM NZ- **Nordmeyer Lecture**
Theatre.

AFTERNOON- Nordmeyer Lecture Theatre

1.30-2.30 Chair: Prof Bill Glass
Keynote Address – Dr Ron Loeppke
“The power of prevention in linking
occupational health and primary care for
integrated population health management.”

2.30-3.00 Commentators and Discussion: Dr Paul
Gueret/Dr Krishnan/Dr Rob McCartney.

3.00-3.30 Afternoon Tea

Pathways to Occupational Medicine

Chair: Dr Mark Floyd

3.30-4.00 **Paper 1** – Dr Chris Walls

4.00-4.30 **Paper 2** – Dr Tim Rumball

4.30-5.00 **Paper 3** – Dr Tim Gilmore

SATURDAY 3 SEPTEMBER 2011

DAY 2: RESEARCH/MULTI DISCIPLINE

MORNING- Nordmeyer Lecture Theatre

8.00 Registration- **Lobby.**

8.30-9.30 Chair: Dr Simon Ryder-Lewis
Keynote Address – Prof Jeroen Douwes
Research in occupational and public
health in New Zealand.

10.00-10.30 Morning Tea- **Lobby**

10.30-11.00 **Hugh Denehy Oration**
Chair: Dr Rob McCartney

Issues of Surveillance

Chair: Dr Michael Kahan

11.00-11.30 **Paper 1** – Dr Andrea ‘t- Mannelteje:
“Occupational causes for cancer are still
common: some examples from recently
conducted studies”.

11.30-12.00 **Paper 2** – Mr Kerry Cheung: “Real Time
Video Monitoring”.

12.00-12.30 **Paper 3** – Dr Chris Walls: “The
RailCorp Lantern Test”.

LUNCH- Lobby & Cafe

12.30-2.00 Working Lunch – KiwiRail Doctors
Meeting- **Rm D07**
AGM Federal (Aus) ANZSOM- **Small**
Lecture Theatre

AFTERNOON- Nordmeyer Lecture Theatre

2.00-3.00 Chair: Dr David Waite
Keynote Address – Mr Paul Jarvie
“A multidisciplinary approach is a
necessity for a safe and healthy
workplace”.

3.00-3.30 Afternoon Tea

3.30-4.30 **Keynote Address – Mr Les Heads**
“New developments in the practice of
occupational safety”.

4.30-5.00 Commentator and Discussion on both
papers: Dr Geraint Emrys

6.30 for 7.00 **CONFERENCE DINNER- Shed 5,**
Queens Wharf, Wellington City

MORNING- Nordmeyer Lecture Theatre

9.00-10.00 Chair: Dr Rob Griffiths

Keynote Address – Prof Tar-Ching Aw “Challenges for improving provisions for occupational medicine in developing countries”.

10.00-10.30 Morning Tea- **Lobby**

Occasional Papers

Chair: Dr John Guthrie

10.30-11.00 **Paper 1** – Dr Gerard Walker: “An Audit of the clinical quality of Initial Medical Assessments (IMAs) undertaken for the ACC”.

11.00-11.30 **Paper 2** – Dr John Schneider: “Managing work in hot environments - Should you ignore the cardiologists?”

11.30-12.00 **Paper 3** – Dr Fiona Landgren: “National Transport Commission (*Assessing Fitness to Drive*) project”.

12.00-12.30 **Paper 4** – Dr Moazzam Zaidi, Dr. Rob Griffiths: “Lessons Learned in a 2 year prospective study in an emerging multinational healthcare facility”.

12.30-1.00 **CLOSE OF CONFERENCE**

Prof Bill Glass, 1st President, ANZSOM NZ.

Wellington School of Medicine Map



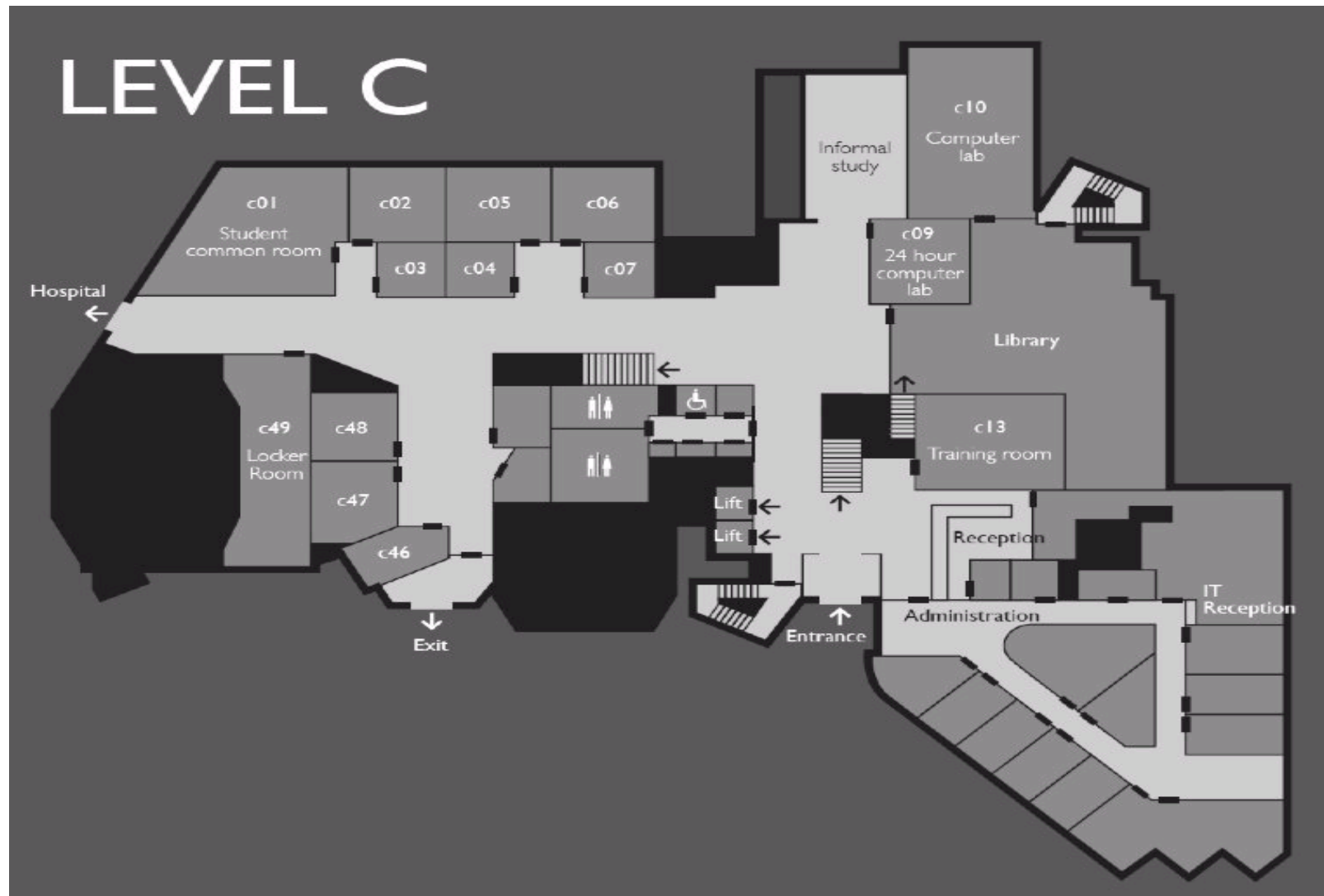

Entry is on Level C then go straight up the stairs to Level D

LEVEL D

